

POLLINATOR-FRIENDLY BORDER

FOR SUNNY AREAS WITH DRY TO MOIST SOIL

SUN: ☀️☔️

SOIL MOISTURE: 💧-💧💧

SEASONAL COLOR: APR-DEC



Sweet pepperbush



Butterfly weed



Wild blue indigo



Purple coneflower



Pink muhly grass



ELEVATION VIEW

DESCRIPTION

The combination of flowering perennials, native ornamental grass and shrubs add year-round interest with texture and color. This design also provides important foraging grounds and habitat for birds, bees and butterflies. Butterfly weed (or milkweed) is a host plant for monarch butterflies. It also readily seeds, so patient gardeners can plant less, letting it naturally colonize over time. If exposure to salt spray is a concern, search for more salt-tolerant plants.

ALTERNATIVE

Shrub substitutes: For dry soils, Adam's needle (*Yucca filamentosa*) is a good choice. Otherwise, opt for inkberry (*Ilex glabra*).

Perennial substitutes: eastern smooth beardtongue (*Penstemon laevigatus*), sand coreopsis (*Coreopsis lanceolata*) or more butterfly weed. Also, add a tall (6-foot) semi-evergreen bush like zenobia (*Zenobia pulverulanta*) on the back of the border for year-round structure.

MAINTENANCE

Prune clethra in winter or early spring, if needed. Cut back grasses in late winter or early spring. Leave an 8-to-12-inch crown on muhly grass.

PLAN VIEW

5' x 20'

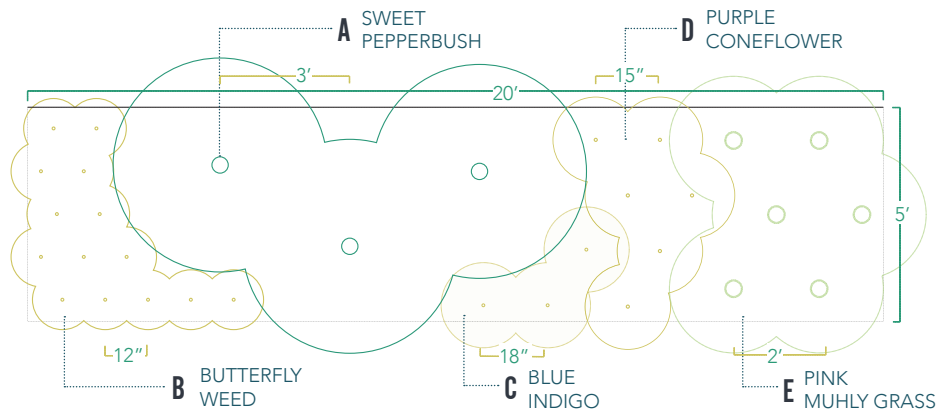

PLANT SELECTION

KEY	QTY	COMMON NAME	BOTANICAL NAME	PLANT TYPE	SPACING	SEASONAL COLOR														
						J	F	M	A	M	J	J	A	S	O	N	D			
A	3	Sweet pepperbush	<i>Clethra alnifolia</i>	SHRUB	3' O.C.															
B	14	Butterfly weed	<i>Asclepias tuberosa</i>	PERENNIAL	12" O.C.															
C	3	Blue wild indigo	<i>Baptisia australis</i>	PERENNIAL	18" O.C.															
D	6	Purple coneflower	<i>Echinacea purpurea</i>	PERENNIAL	15" O.C.															
E	6	Muhly grass	<i>Muhlenbergia capillaris</i>	GRASS	2' O.C.															